

2025

activity guide



Mishawaka Parks and Recreation

mishawaka.in.gov/parksandrecreation





BATTELL COMMUNITY CENTER

904 North Main Street

Mishawaka, IN 46545

(574) 258-1664

parks@mishawaka.in.gov

OFFICE HOURS:

Monday – Thursday:

8:00 am – 8:00 pm

Friday

8:00 am – 5:00 pm

Saturday – Sunday:

Closed

PARK HOURS:

7:00 am – 10:00 pm

SPLASH PAD LOCATIONS:

Battell Park, Crawford Park, Central

Park, Mary Gibbard Park, Rose

Park, Twin Branch Park

SPLASH PAD HOURS:

Open daily

Memorial Day through Labor Day

11:00 am – 8:00 pm

Like and Follow



Facebook:

@MishawakaParks



Instagram:

@mishawakaparks



Welcome to Mishawaka

Mishawaka is blessed with 28 public parks, each with its own unique natural attributes. For boating enthusiasts, there are four parks with boat launches on the St. Joseph River. Water skiers and sailors can indulge in their pastimes on the river's east section. Coincidentally, this is one of the best rivers in the state for fishing. Smallmouth bass, steelhead trout, coho salmon, chinook salmon and walleye are plentiful in their seasons.

Mishawaka Parks also boasts an Olympic-size swimming pool, six splash pads and accommodations for tennis, pickleball, sand volleyball and basketball. The 18-hole Eberhart-Petro Golf Course offers traditional golfers finely groomed fairways and greens while George Wilson Park and Henry Frank Parks offer disc golfers challenging disc golf courses. In the winter, skaters can show off their skills on the ice ribbon at the Ironworks Ice Rink or slide down the tubing hills of George Wilson Park. Enjoy a cold beverage at the Ball Band Biergarten and listen to the music of some of our talented local music acts during our Summer Concert Series. Browse a selection of local vendors during our popular Sunday Mishawaka Market along Ironworks Avenue.

Credit cards are accepted at all park facilities and online registration.

Registrations online: mishawaka.recdesk.com/Community/Home.

Table of Contents

Park Information & Table of Contents	2-3	Battell Community Center Rec Clubs	27
Indoor Youth Sports	4	Battell Community Center	
Outdoor Youth Sports	5-6	Facility Rental	28-29
Recreational Sports, Clubs & Leagues	7	Park Pavilion Rentals	30
Activities	8	Outdoor Rentals	31
Special Events	9-14	Ball Diamond & Building Rentals	32
Joint Ventures	15	Adopt a Park	33
Adventure Day Camp	16-18	Off-Leash Dog Run	34
Spring & Fall Camp	19	Mishawaka Parks & Recreation	
Merrifield Pool	20-21	Foundation	35
Ironworks Ice Rink	22-23	Park Amenities	36-37
Eberhart-Petro Golf Course	24	Sponsorship Opportunities	38
George Wilson Park	25	Refund Policy	39
Battell Community Center	26		

Get to Know Your Parks & Recreation Team

ADMINISTRATION

Superintendent of Parks
Phil Blasko
pblasko@mishawaka.in.gov

Director of Operations
Yvonne Teeter
(574) 258-1664 ext. 4001
yteeter@mishawaka.in.gov

Receptionist
Dana Dinger
dana.dinger@mishawaka.in.gov

CAMP AND COMMUNITY ENGAGEMENT

Director
Lauren McGowan
(574) 258-1664 ext. 4005
lauren.mcgowan@mishawaka.in.gov

SPECIAL EVENTS AND ACTIVITIES

Director
Jordy Rush
(574) 258-1664 ext. 4007
jordyn.rush@mishawaka.in.gov

RECREATION AND FACILITIES

Director
Steven Gleissner
(574) 258-1664 ext. 4008
sgleissner@mishawaka.in.gov

BATTELL COMMUNITY CENTER

Director
Clare Kopeck
(574) 258-1664 ext. 4002
ckopec@mishawaka.in.gov

AQUATICS AND ICE RINK

Director
Marissa Gruler
mgruler@mishawaka.in.gov
Merrifield (574) 258-1665
Ironworks (574) 208-5552

Assistant
Kaylee Navarro
kaylee.navarro@mishawaka.in.gov

GOLF

Director of Golf Operations
Andrew Roop
(574) 255-5508
aroop@mishawaka.in.gov

Golf Course Superintendent
George Fowler
(574) 258-1611
gfowler@mishawaka.in.gov

**Assistant Golf Course
Superintendent**
Ryan Weaver
rweaver@mishawaka.in.gov

LANDSCAPE

Director
Jacob Crawford
(574) 258-1664 ext. 4009
jcrawford@mishawaka.in.gov

Assistant
Kayla Valentiny
kayla.valentiny@mishawaka.in.gov

IRONWORKS PROGRAM AND EVENTS

Director
Kaylan O'Connell
(574) 258-1664 ext. 4004
kaylan.oconnell@mishawaka.in.gov

BOARD OF DIRECTORS

John Coppens, President
Pat Hahn, Vice President
Carolyn A. Teeter, Secretary
Naomi Rea, Member
Jerome Calderone, Member
Jenny McNeil, Member

BOARD MEETINGS

Held on the second and fourth
Monday of each month.
4:30 pm in the Auditorium at the
Battell Community Center
904 North Main Street
Mishawaka, IN 46545

INFO

Holiday Observed Dates

New Year's Day – January 1
Observed Monday, January 1

Good Friday – April 18
Observed Friday, April 18

Memorial Day – May 26
Observed Monday, May 26

Independence Day – July 4
Observed Friday, July 4

Labor Day – September 1
Observed Monday, September 1

Veteran's Day – November 11
Observed Tuesday, November 11

Thanksgiving Day – November 27
Observed Thursday, November 27

Day after Thanksgiving – November 28
Observed Friday, November 28

Christmas Eve – December 24
Observed Wednesday, December 24

Christmas Day – December 25
Observed Thursday, December 25

Indoor Youth Sports

The Mishawaka Parks Department recreational youth leagues are first and foremost intended to provide a positive social experience with an emphasis placed on good sportsmanship, fun, and exercise. Our number one goal for our programs is to make sure kids come smiling and leave smiling!

Battell Center Youth Sports Leagues

Soccer

This five-week program will be separated into two leagues: ages 5 – 6 and 7 – 8. Rules will be modified to help kids have a great time learning the basics and fundamentals of soccer. Late registration for this league is subject to a \$25 late fee.

Registration ends December 30th

Practice begins January 15th

Ages: 5 to 8

Cost: \$60, includes t-shirt

Game dates: Saturdays, January 25th – February 15th

[Season: 4 games]

Location: Battell Community Center

Volleyball

This five-week program will be separated into two leagues: ages 5 – 6 and 7 – 8. Rules will be modified to help kids have a great time learning the basics and fundamentals of volleyball. Late registration for this league is subject to a \$25 late fee.

Registration ends February 25th

Practice begins March 12th

Ages: 5 to 8

Cost: \$60, includes t-shirt

Game dates: Saturdays, March 22nd – April 12th

[Season: 4 games]

Location: Battell Community Center

Basketball

This five-week program will be separated into three leagues: ages 3 – 4, 5 – 6, and 7 – 9. Rules will be modified to help kids have a great time learning the basics and fundamentals of basketball. Late registration for this league is subject to a \$25 late fee. No basketball practice on Wednesday, October 22nd and no basketball games on Saturday, October 25th.

Registration ends September 8th

Practice begins October 1st

Ages: 3 to 9

Cost: \$60, includes t-shirt

Game dates: Saturdays, October 11th – November 8th

[Season: 4 games]

Location: Battell Community Center | John Young Middle School



Battell Community Center location:
904 North Main Street

John Young Middle School location:
1801 North Main Street

Need more information regarding
Indoor Youth Sports? Email Clare Kopec
at ckopec@mishawaka.in.gov

*Fees and charges are subject to change without prior notice.
No refunds will be issued for Indoor Youth Sports registrations.*

Outdoor Sports

Youth Soccer

Provides a positive recreational soccer experience for children ages 3 to 9 years old. Striving to maintain a balance between teaching progressive soccer skills, sportsmanship, and healthy competition. Games are played on Saturday mornings; times will vary. Practice day, time, and location are set by the team's volunteer coach. Teams are formed at random by friend and coaches' request. Younger siblings may play up an age group, if needed. Late registration for this league is subject to a \$25 late fee.

Spring Soccer Season

Registration ends March 17th

Practice begins week of April 7th

Ages: 3 to 9

Cost: Age 3 – 5, \$60 | Ages 6 – 9, \$70, includes t-shirt & socks | After March 17th, \$25 late fee in addition, if registration spaces are still available.

Game dates: Saturdays, April 19th – May 17th [Seasons: age 3 – 5, 4 games | ages 6 – 9, 5 games]

Location: Merrifield Park

**Note: Practice day, time, and location are set by the team's volunteer coach.*

**Location subject to change, due to road construction*

Fall Soccer Season

Registration ends August 18th

Practice begins week of September 8th

Ages: 3 to 9

Cost: Age 3 – 5, \$60 | Ages 6 – 9, \$70, includes t-shirt & socks | After August 18th, \$25 late fee in addition, if registration spaces are still available.

Game dates: Saturdays, September 20th – October 18th [Seasons: age 3 – 5, 4 games | ages 6 – 9, 5 games]

Location: Merrifield Park

**Note: Practice day, time, and location are set by the team's volunteer coach.*



Youth T-Ball

Provides a positive recreational baseball experience for children ages 3 to 8 years old. Striving to maintain a balance between teaching progressive baseball skills, sportsmanship, and healthy competition. Games are played on Tuesday and Thursday evenings and Saturday mornings; times will vary. Practice day, time, and location are set by the team's volunteer coach. Teams are formed at random by friend and coaches' request. Younger siblings may play up an age group, if needed. Late registration for this league is subject to a \$25 late fee.

Registration ends May 5th

Practice begins week of May 26th

Ages: 3 to 8

Cost: Age 3, \$60 | Ages 4 – 8, \$70, includes game t-shirt and MLB style hat | After May 5th, \$25 late fee in addition, if registration spaces are still available.

Game dates: Tuesdays, Thursdays, Saturdays, June 7th – June 26th [Seasons: age 3, 4 games | ages 4 – 8, 5 games]

Location: Heroes Park

**Note: Practice day, time, and location are set by the team's volunteer coach.*



SUMMER YOUTH TENNIS CAMP

Recreational youth tennis camps focusing on introductory to intermediate tennis skills for kids ages 3 to 13 years old. Registration for each space is limited. Session dates and times will be available at a later date.

Ages: 3 to 13

Cost: \$45, includes t-shirt

Location: Battell Park Tennis Courts

Outdoor Sports

Youth Track & Field

Recreational youth track program designed to introduce kids to the basic track and field style events, including 30 m/60 m dash, hurdles, long jump, softball and Frisbee throw – all modified for children. Programs will consist of group practices and meets. Late registration for this league is subject to a \$25 late fee.

Registration ends July 7th

Practice dates: Wednesdays, July 16th | July 23rd
[2 practices]

Meet Dates: Saturdays & Wednesday, July 19th | July 26th | July 30th [3 meets]

Ages: 6 to 12

Cost: \$45, includes t-shirt

Practice Times: 6:00 – 7:00 pm

Meet Times: Saturdays, Ages 6 – 8, 9:00 – 10:00 am |
Ages 9 – 12, 10:15 – 11:15 am | Wednesday, Ages 6 – 8,
6:00 – 7:00 pm | Ages 9 – 12, 7:00 – 8:00 pm

Location: John Young Middle School

**Note: Limited registration space is available.*

Youth Flag Football

Introduce your child to the game of football in a less physical environment. Youth flag football will teach beginner players the basic rules and skills used for football. Games will be played on Sunday afternoons. Practice day, time, and location are set by the team's volunteer coach. Late registration for this league is subject to a \$25 late fee.

Registration ends August 18th

Practice begins week of September 8th

Grades: 1st to 4th

Cost: \$70, includes games t-shirt & flags | After August 18th, \$25 late fee in addition, if registration spaces are still available.

Game dates: Sunday, September 21st – October 19th
[Season: 5 games]

Game Location: John Young Middle School |
Mishawaka High School

**Note: Practice day, time, and location are set by the team's volunteer coach.*

Mishawaka High School Youth Tackle Football

Youth Tackle Football league for those in 5th and 6th grade. Run by the Mishawaka High School football coaching staff. Includes weekly practices and games at Mishawaka High School. A helmet, shoulder pads, pants and game jersey will be provided.

Registration ends August 11th

Grades: 5th to 6th

Cost: \$80, includes equipment rental | After June 30th, \$100

Practices: Tuesdays & Wednesdays; Practice days subject to change

Game dates: Sunday, September – October; Games days subject to change

Practice Location: Mishawaka High School

**Equipment rental includes the following for the season: helmet, shoulder pads, pants and jersey*



Need more information regarding
Outdoor Youth Sports?
Email Steven Gleissner at
sgleissner@mishawaka.in.gov

*Fees and charges are subject to change without prior notice.
No refunds will be issued for Outdoor Youth Sports registrations.*

Recreational Sports, Clubs, Leagues

Best Damn Sports and Social Club

Featuring co-ed kickball, sand volleyball, dodgeball and more!

For more information,
visit www.bestdamnmichiana.com.

Michiana Pickleball Association

Pickleball is a fast-growing sport that combines elements of tennis, badminton, and ping-pong. Whether you're looking for a low-impact workout, a chance to socialize, or a competitive outlet, pickleball has something for everyone. Join the fun, stay active, and experience why pickleball is sweeping the nation! Sign up today and be part of the action.

For more information, email michianapickleball@gmail.com or call (574) 344-9393.

Mid-America Senior Softball

Senior Softball is a vibrant and inclusive sport designed for adults aged 50 and over. It's a great way to stay active, improve your fitness, and enjoy friendly competition. Whether you're a seasoned player or new to the game, Senior Softball offers a welcoming environment for all skill levels.

Monday and Wednesday.

Website, www.michianaseniorsoftball.org

Michiana Disc Golf Association [MDGA]

Disc golf league; random draw doubles, best shot. Start time varies by month. For more information, check out the MDGA disc golf page.

Dates: Wednesday | Thursdays

Time: Start times vary by month

Location: Wednesday, George Wilson Park | Thursday, Henry Frank Park



Activities For The Entire Family

Greenhouse Storytime

Join us as we partner with the Mishawaka Penn-Harris County Library for Greenhouse Storytime! Once a month we invite all little ones to come over to the MEF Community Greenhouse for a story hour and take-home crafts from the library. After Storytime, kids will learn about the growing cycles of the plants and will be able to pick what's in bloom.

Dates: 2nd Monday of the month, June – August

Cost: Free

Time: 5:30 – 6:30 pm

Location: MEF Community Greenhouse



Summer Concert Series

Join the Mishawaka Parks Department for our annual Summer Concert Series! We will have Monday Concerts at the Battell Park Bandshell, 7:00 – 8:30 pm, Wednesday Concerts at the Ball Band Biergarten, 6:30 – 8:30 pm, and Thursday evening Concerts at Central Park, 6:00 – 8:00 pm! All concerts are FREE to attend, family-friendly, and feature local artists. If you are interested in performing, please contact the Parks Department! No Concert Wednesday, July 16th.

Date: June 2nd – August 28th

Cost: Free

Location: Battell Park | Ball Band Biergarten | Central Park

For the Win Food Truck Wednesday

Looking for a mid-week pick-me-up? Head down to the Ball Band Biergarten for lunch! We will have a variety of food vendors for you to purchase food from. Enjoy lunch in the park or take it to go. Interested in being a vendor? Contact Kaylan O'Connell at kaylan.oconnell@mishawaka.in.gov.

Date: 1st & 3rd Wednesday, June & July

Time: 11:00 am – 2:00 pm

Location: Ball Band Biergarten

Food Truck Friday

Looking for an easy dinner on a Friday? Come down to the Ball Band Biergarten for dinner! We will have a variety of food vendors for you to purchase from. Enjoy your dinner at the Biergarten or take it to-go. Interested in being a vendor? Contact Kaylan O'Connell at kaylan.oconnell@mishawaka.in.gov.

Date: 2nd & 4th Friday, June & July

Time: 5:30 – 8:30 pm

Location: Ball Band Biergarten

Mishawaka Market

Come down to Ironworks Plaza and get a taste of home grown. We are excited for year seven of our market. We will have produce, baked goods, and homemade crafts. The market runs from 10:00 am – 2:00 pm on Sundays, rain or shine. Be sure to follow the market on Facebook @mishawakamarket. Interested in being a vendor? Contact Kaylan O'Connell at kaylan.oconnell@mishawaka.in.gov. No market Sunday, June 15th, July 6th, August 31st.

Dates: Sundays, June 1st – September 28th

Time: 10:00 am – 2:00 pm

Location: Ironworks Plaza



Special Events

Seed Swap

Bring your seeds and swap them with other gardeners in the Mishawaka area. Bags need to be clearly labeled.

Date: January 25th

Cost: Free

Time: 11:00 am – 1:00 pm

Location: Ironworks Event Center

Girls Night Out

Bring your girlies for a night out! Get dressed up in your favorite decade and dance the night away!

Date: February 8th

Cost: \$15

Time: 7:00 – 9:00 pm

Location: Ironworks Event Center

Daddy Daughter Dance

Enjoy a themed evening of dancing, light refreshments, music, and quality time with your daughter. The dance is open to girls ages 4 – 12, escorted by an adult family member.

Date: February 21st

Cost: \$45 per couple | \$10/add'l daughter

Time: 7:00 – 9:00 pm

Location: Battell Community Center

Mother Son Dance

Enjoy a themed evening of dancing, light refreshments, music, and quality time with your son. The dance is open to boys ages 4 – 12, escorted by an adult family member.

Date: February 22nd

Cost: \$45 per couple | \$10/add'l son

Time: 7:00 – 9:00 pm

Location: Battell Community Center

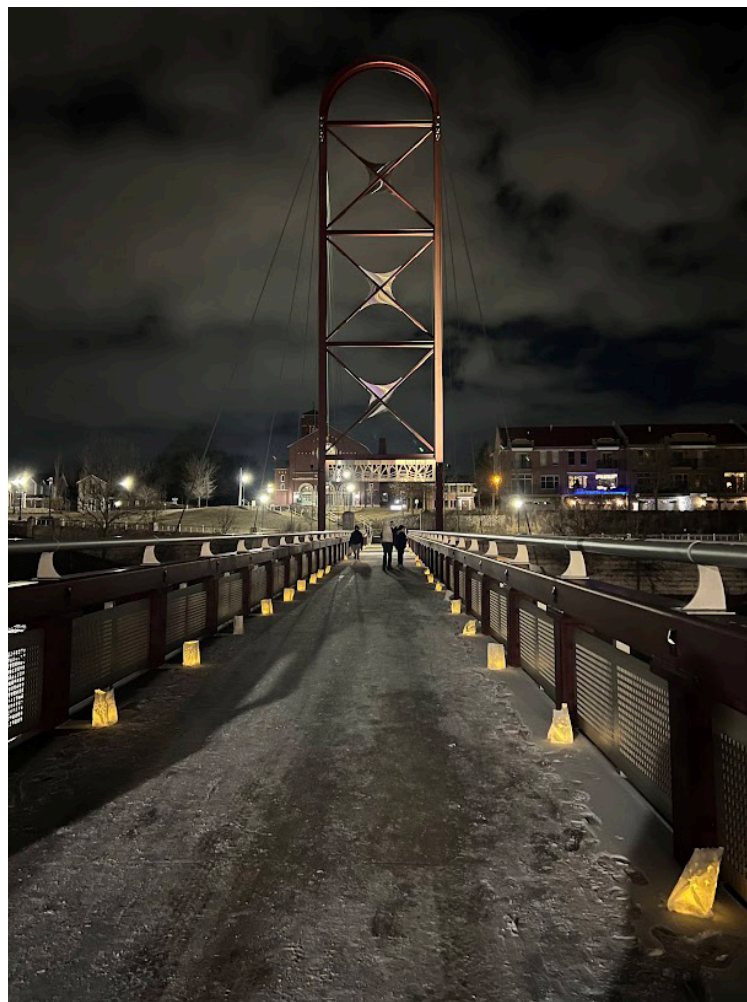

Luminary Walk

Shake off those winter blues and join us for a lighted Luminary Walk! Guests will walk a lighted trail through the park, and the evening will end with music and hot chocolate by the fire!

Date: March 8th

Cost: Free

Time: 6:30 – 8:30 pm

Location: Mishawaka Riverwalk

Whiskey Warmer

Join the fun and give back to the community by helping fundraise at Mishawaka's Whiskey Warmer! Taste local whiskeys and specialty cocktails and enjoy music. Food presented by local vendors.

Date: March 29th

Ages: 21+

Cost: \$25

Time: 6:00 – 9:00 pm

Location: Ironworks Event Center

**Note: No refunds will be given for Special Events & Activities registrations.*

www.mishawaka.in.gov/parksandrecreation

Special Events

Derby Day

Saddle up and head down to the Ball Band Biergarten. We will be showing the Kentucky Derby LIVE on the big screen for the evening. Place some “bets” and wear your derby hats to win prizes. Food and drinks will be available for purchase at the event.

Date: May 3rd
Ages: All ages
Cost: \$10
Time: 2:00 – 8:00 pm
Location: Ball Band Biergarten

Tribute Fest

Join us at Central Park for our new festival, Tribute Fest! Featuring tribute bands of the finest musical artists in history! Local food trucks, beverages, and vendors.

Date: May 10th
Cost: \$15
Time: 4:00 – 10:00 pm
Location: Central Park



Kids to Parks Day

Along with the National Park Trust, we are excited to spend a day celebrating all the joy of Mishawaka's parks bring the community all year long! We will be hosting an event filled with games, activities, and community partners and all are welcome to join us as we #GETOUTANDPLAY!

Date: May 17th
Cost: Free
Time: 11:00 am – 1:00 pm
Location: Hillis Hans Park



Community Yard Sale

Join your neighbors in giving gently used, unwanted items of all kinds a second life at our annual Community Yard Sale. Interested in selling? Email Clare Kopec at ckopec@mishawaka.in.gov.

Date: May 31st
Cost: Booth Space, \$40
Time: 9:00 am – 1:00 pm
Location: Battell Community Center



Mishawaka RETROFEST!

Get ready to TURN BACK TIME at Ironworks Plaza with our third annual Mishawaka RETROFEST! Bands including the 1985 (80s), Fool House (90s), and more playing your favorites from decades past. We'll have food trucks, a kids area and more!

Date: June 14th
Cost: In advance \$5 | At gate \$10
Time: 2:00 – 10:00 pm
Location: Ironworks Plaza

**Note: No refunds will be given for Special Events & Activities registrations.*

Special Events

Independence Day Celebration

Celebrate our Nation's Independence Day with us at our 9th annual Independence Day Celebration! The day will feature live music, kids' games and activities, food, arts and crafts, a car show, and FIREWORKS! This is an event you won't want to miss!

Date: June 28th

Cost: Free to attend

Time: 5:00 pm | Fireworks at dusk

Location: Central Park



Foam Fest

It's a day full of foam-tastic fun and games! Join us at Ironworks Plaza for the biggest foam party of the summer.

Date: July 12th

Cost: \$10

Time: 11:00 am – 1:00 pm

Location: Ironworks Plaza

**Note: No refunds will be given for Special Events & Activities registrations.*

www.mishawaka.in.gov/parksandrecreation

Special Events

Chill with a Cop at National Night Out

Join the Mishawaka Police Department and the Mishawaka Parks Department for an evening of free fun, frozen treats, and conversation! National Night out + Chill with a Cop enhances the relationships between neighbors and law enforcement while bringing back a true sense of community. Furthermore, it provides a great opportunity to bring police and neighbors together under positive circumstances. The event will include popsicles, games, inflatables, a DJ, Safety Pup and MORE!

Dates: August 5th

Cost: Free

Time: 5:00 – 7:00 pm

Location: Merrifield Park



Slide the Hill

Slip-n-Slide down “The Hills” on a giant foam and water slip-n-slide. Online pre-registration is required to attend this event. Registration can be done at: <https://mishawaka.recdesk.com/Community/Home>.

Dates: August 8th – August 11th

Ages: All ages

Cost: Admission \$7 | Tubes \$8

Times:

Session 1: Friday, August 8th, Pre-School and People with different abilities | 3:00 – 5:00 pm

[gates open at 2:45 pm]

Session 2: Friday, August 8th, 6:00 – 8:00 pm

[gates open at 5:45 pm]

Session 3: Saturday, August 9th, 1:00 – 3:00 pm

[gates open at 12:45 pm]

Session 4: Saturday, August 9th, 4:00 – 6:00 pm

[gates open at 3:45 pm]

Session 5: Sunday, August 10th, 1:00 – 3:00 pm

[gates open at 12:45 pm]

Session 6: Monday, August 11th, 11:00 am – 1:00 pm

[gates open at 10:45 am]

Location: George Wilson Park

**Note: Providing your own tube is preferred. Everyone entering the park must pay \$8 fee. This includes spectators.*

Special Events

Color Fun Run

Dress in your best 80's attire and head down to Central Park for the color run you won't want to miss! This event is all about living it up and having a blast! Prizes will be given for the best dressed 80's look. Registration comes with t-shirt, sunglasses, and packet of color. T-shirts, sunglasses, and packet of color are only guaranteed for those who are pre-registered.

Registration ends August 13th

Date: August 23rd

Cost: \$30

Time: Race day registration and packet pick-up, 9:00 am | Run starts, 10:00 am

Location: Ironworks Plaza

**Note: Starting August 6th, late registration fees take effect, \$35. Late registration ends August 13th. After late registration, you can register the day of the event from 9:00 – 9:45 am.*



Country Fest

Put on your cowboy boots and join the Parks Department and B100 for our third annual Country Fest. Come down to Ironworks Plaza for an evening filled with all things country. We will have food trucks, a kids' zone and more!

Date: September 6th

Cost: TBD

Time: 3:00 – 10:00 pm

Location: Ironworks Plaza



Monster Dash & Dance!

Who is ready for a Halloween fun run?! Participants will run the length of Ironworks Avenue dressed in their spooky best. At the end of the run, participants will receive a small pumpkin to decorate and a cup of hot chocolate. After the run, we will have music playing for the kids to dance out to some monster boogie tunes.

Date: October 10th

Ages: 3 to 9

Cost: \$5

Time: 6:00 – 8:00 pm

Location: Ball Band Biergarten

Boos & Brews, Haunted Brew Fest

We don't want the adults to feel left out of the spooky season, so join us for the 21+ Boos and Brews, Haunted Brew Fest! We've invited local breweries to pour their favorites! Wear your best costume! A costume contest will be held for the best individual and best couple at the end of the night. Each guest will receive a sample cup with the purchase of a ticket. Designated drivers are welcome to attend to ensure everyone gets home safely.

Date: October 17th

Ages: 21+

Cost: \$30 | Designated Driver: \$10

Time: 6:00 – 9:00 pm

Location: Ball Band Biergarten



Table-or-Treat the Riverwalk

Come trick-or-treat with us and local businesses along the Mishawaka Riverwalk. There will be spooky surprises, music, and of course, candy! Interested in hosting a table and passing out candy? Email Clare Kopec at ckopec@mishawaka.in.gov

Date: October 25th

Ages: All are welcome

Cost: Free

Time: 5:00 – 7:00 pm

Location: Mishawaka Riverwalk

Special Events

Flannel Formal

Calling all our lumberjacks and lumberjanes, Flannel Formal is back for another year! Dress in your best flannel attire and head to the Ball Band Biergarten for axe-throwing, live music, and drinks around the fire. This is a 21+ and IDs will be checked at the door!

Date: November 7th

Cost: \$10

Time: 7:00 – 10:00 pm

Location: Ball Band Biergarten



Holiday Craft Fair

Get into the festive spirit at our curated Holiday Craft Fair on Saturday, November 15th from 9:00 am – 1:00 pm located in the Battell Community Center. This delightful event features a wide array of handcrafted items, unique jewelry, and charming décor, perfect for early holiday shopping. Bring the whole family for a day of fun, including the chance to snap a special photo with Santa! Best of all, admission is free! Don't miss out on this wonderful opportunity to support local artisans and find one-of-a-kind gifts! Mark your calendars and join us for a joyful celebration of creativity and community.

Date: November 15th

Cost: Booth Space, \$40

Time: 9:00 am – 1:00 pm

Location: Battell Community Center

Winterfest

Join us for the annual Winterfest Celebration! One of the best events of the year, we will kick things off with a lighted parade and tree lighting at Ironworks Ave! The event will include food vendors, a holiday market, pictures with Santa, trackless train rides, ice carving, fire performers, axe-throwing, and of course, ice skating!

Date: December 6th

Cost: Free

Time: 5:00 – 8:00 pm

Location: Ironworks Plaza



Joint Ventures

The Musical Adventures of Flat Stanley presented by the South Bend Civic Theater

The beloved children's book, written by Jeff Brown in 1964, has become a literary and pop cultural phenomenon, delighting readers and travelers all around the world. And now, Timothy Allen McDonald, the writer behind *Willy Wonka* and *James and the Giant Peach*, has taken everyone's favorite two-dimensional hero and given him a new life in *The Musical Adventures of Flat Stanley*.

Stanley Lambchop is your ordinary, everyday, run-of-the-mill, ten-year-old: normal mom and dad, normal little brother, normal life. That's just the problem... for Stanley, life is too normal. He wants to travel the world, do something amazing, something no one's ever seen before. Careful what you wish for, Stanley! One night, the bulletin board on the wall above Stanley's bed comes loose and falls – right on top of Stanley! The next morning, Stanley Lambchop wakes up flat. Not just a little flat... really, REALLY flat! In a whirlwind musical travelogue, Stanley – the ultimate exchange student – scours the globe for a solution to his unusual problem. He's stamped, posted and cancelled from Hollywood and France to Honolulu and beyond. And, whether he's thwarting a robbery at the Louvre Museum in Paris, or "hanging ten" off the coast of Hawaii, Stanley is closing in on his goal of being a three-dimensional boy once more.

Dates: March 27th | March 28th | March 29th | April 4th | April 5th
Cost: Ticket prices & purchases at: sbt.org
Time: March 27th & March 28th 7:30 pm | March 29th 2:00 pm & 7:30 pm | April 4th 7:30 pm | April 5th 2:00 pm & 7:30 pm
Location: Auditorium, Battell Community Center

Studebaker Car Show

Calling all car enthusiasts! At this unique exhibition, you'll witness a spectacular display of vintage wheels, each with its own story and history. Mark your calendar and come experience a free Studebaker Car Show from the South Bend Chapter – Studebaker Driver's Club.

Date: May 30th
Cost: Free
Time: 6:00 – 8:30 pm
Location: Ironworks Plaza



Robofest in the Plaza

Come join us for Robofest in the Plaza as we partner with the Mishawaka Robotics team to turn our plaza into a robot battlefield. The Mishawaka Robotics team will be bringing out their robots and other items that are made by the students within School City of Mishawaka.

Date: June 7th
Cost: Free
Time: 10:00 am – 2:00 pm
Location: Ironworks Plaza

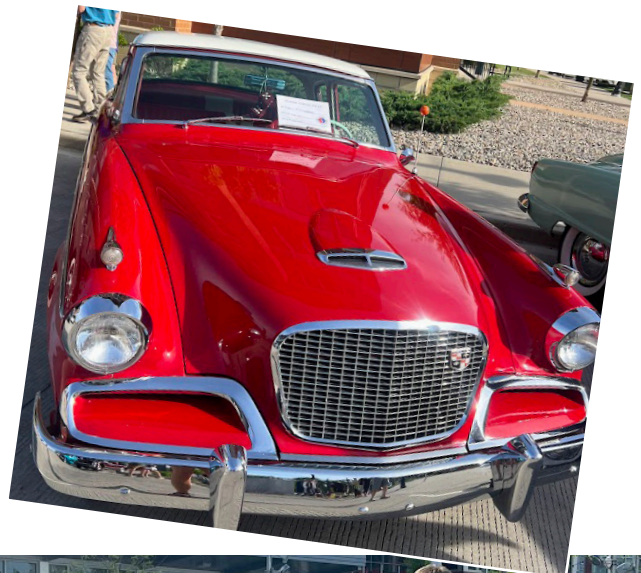

Adventure Day Camp

Looking for some summer fun? Our summer day camp provides a safe and nurturing environment where children can have fun and make new friends! All camp activities are created around exciting weekly themes with an emphasis on building confidence, resilience, responsibility, and problem-solving skills.

Explorers

The Explorers Adventure Day Camp will be held at the Battell Community Center for children ages 4 – 5 years old. Campers will have the opportunity to enjoy guests, field trips, and movie days! Explorers' lunches will be provided Monday – Friday. Camp will make daily trips to Central Park (weather dependent). Field trips and guest visitors to be determined.

Date: June 2nd – August 1st

Ages: 4 to 5

Weekly cost: January 1st – March 1st \$140 | After March 1st \$150

Times: 8:00 am – 3:00 pm

PM Care: 3:00 – 5:00 pm: \$30

Late Registration Fee: \$25

Location: Battell Community Center

**Note: Drop off starts at 8:00 am.*

**Note: Registration closes the Wednesday before each week of camp starts. If registering after Wednesday, subject to a late fee.*



Adventure Day Camp is held at Battell Community Center. 904 N. Main St.

Need more information?

Email Lauren McGowan at

lauren.mcgowan@mishawaka.in.gov

**Note: No refunds will be given for Adventure Day Camp registrations.*

Week 1: Aloha Summer! — 6/2 – 6/6

We're kicking off the summer with a luau! Join us for a week of Polynesian-themed activities.

Week 2: Meet Me on the Map — 6/9 – 6/13

Join us as we travel around the map and explore different areas of our world! A field trip to South Bend Chocolate to be determined.

Week 3: Prehistoric Party — 6/16 – 6/20

Time travel back to prehistoric times with us! Learn about different dinosaurs and their daily routines when they roamed the earth. A field trip to South Bend Dinosaur Museum to be determined.

Week 4: Wonderful World of Wizardry — 6/23 – 6/27

Calling all wizards! If your child loves the world of magic, they will love jumping into the fantasy world of wizards for this camp. We will create our own wands, be sorted into houses and learn to write with quills!

Week 5: Sports of all Sorts — 6/30 – 7/3, (No Camp 7/4)

Campers can explore different sports and learn what they like or love!

Week 6: The Great Outdoors — 7/7 – 7/11

Take a trip to the great outdoors with us! We'll explore nature and take a minute to appreciate the beauty of the world around us. A field trip to St. Pat's County Park to be determined.

Week 7: Going Wild — 7/14 – 7/18

Calling all animal lovers! Join us for a week of learning about the WILD! Visitors from Potawatomi Zoo to be determined.

Week 8: Decades — 7/21 – 7/25

Dance through the decades with us this week! We'll explore the 60s, 70s, 80s and 90s! Themed clothing is always welcome, but never required.

Week 9: We Are Family — 7/28 – 8/1

Join us for a celebration of our last week of camp! Campers sign "yearbooks" and wish each other well before heading out for the summer!

Pathfinders Day Camp

Join the fun at The Pathfinders Day Camp at Castle Manor for kids ages 6–9! Enjoy themed weeks with crafts, activities, special guests, field trips, movie days, and daily Merrifield Pool visits (weather permitting). Lunches are provided Monday–Friday. Don't miss out—sign up today!

Pathfinders

The Pathfinders camp will be held at Castle Manor for children ages 6 – 9 years old. Each themed week will feature crafts, activities, and fun! Campers will have the opportunity to enjoy special guests, field trips, and movie days! Pathfinders' lunches will be provided for them Monday – Friday. Camp will make daily trips to the Merrifield Pool (weather dependent). Field trips and guest visitors to be determined.

Date: June 2nd – August 1st

Ages: 6 to 9

Weekly cost: January 1st – March 1st \$140 | After March 1st \$150

Times: 8:00 am – 3:00 pm

PM Care: 3:00 – 5:00 pm: \$30

Late Registration Fee: \$25

Location: Castle Manor in Merrifield Park

**Note: Drop off starts at 8:00 am.*

**Note: Registration closes the Wednesday before each week of camp starts. If registering after Wednesday, subject to a late fee.*



Pathfinders Day Camp is held at Castle Manor, 801 North Indiana Avenue

Need more information?

Email Lauren McGowan at

lauren.mcgowan@mishawaka.in.gov

**Note: No refunds will be given for Pathfinders Day Camp registrations.*

Week 1: Aloha Summer! — 6/2 – 6/6

We're kicking off the summer with a luau! Join us for a week of Polynesian-themed activities.

Week 2: Meet Me on the Map — 6/9 – 6/13

Join us as we travel around the map and explore different areas of our world! A field trip to South Bend Chocolate to be determined.

Week 3: Prehistoric Party — 6/16 – 6/20

Time travel back to prehistoric times with us! Learn about different dinosaurs and their daily routines when they roamed the earth. A field trip to South Bend Dinosaur Museum to be determined.

Week 4: Wonderful World of Wizardry — 6/23 – 6/27

Calling all wizards! If your child loves the world of magic, they will love jumping into the fantasy world of wizards for this camp. We will create our own wands, be sorted into houses and learn to write with quills!

Week 5: Sports of all Sorts — 6/30 – 7/3, (No Camp 7/4)

Campers can explore different sports and learn what they like or love!

Week 6: The Great Outdoors — 7/7 – 7/11

Take a trip to the great outdoors with us! We'll explore nature and take a minute to appreciate the beauty of the world around us. A field trip to St. Pat's County Park to be determined.

Week 7: Going Wild — 7/14 – 7/18

Calling all animal lovers! Join us for a week of learning about the WILD! Visitors from Potawatomi Zoo to be determined.

Week 8: Decades — 7/21 – 7/25

Dance through the decades with us this week! We'll explore the 60s, 70s, 80s and 90s! Themed clothing is always welcome, but never required.

Week 9: We Are Family — 7/28 – 8/1

Join us for a celebration of our last week of camp! Campers sign "yearbooks" and wish each other well before heading out for the summer!

Navigators Day Camp

Join The Navigators Day Camp! For kids ages 10–12, this summer adventure features themed weeks, crafts, activities, and fun at the Ironworks Event Center. Enjoy special guests, field trips, movie days, and Friday visits to Crawford Park and Merrifield Pool (weather permitting). Lunch is included. Sign up now!

Navigators

The Navigators camp will be held at the Ironworks Event Center for children ages 10-12 years old. Each themed week will feature crafts, activities, and fun! Campers will have the opportunity to enjoy special guests, field trips, and movie days! Navigator's lunches will be provided for them Monday-Friday. On Fridays, we will host camp at Crawford Park with a visit to Merrifield Pool (weather dependent). Field trips and guest visitors to be determined.

Date: June 2nd – August 1st

Ages: 10 to 12

Weekly cost: January 1st – March 1st \$140 |
After March 1st \$150

Times: 8:00 am – 3:00 pm

PM Care: 3:00 – 5:00 pm: \$30

Late Registration Fee: \$25

Location: Ironworks Event Center

**Note: Drop off starts at 8:00 am.*

**Note: Registration closes the Wednesday before each week of camp starts. If registering after Wednesday, subject to a late fee.*



Week 1: Aloha Summer! — 6/2 – 6/6

We're kicking off the summer with a luau! Join us for a week of Polynesian-themed activities.

Week 2: Meet Me on the Map — 6/9 – 6/13

Join us as we travel around the map and explore different areas of our world! A field trip to South Bend Chocolate to be determined.

Week 3: Prehistoric Party — 6/16 – 6/20

Time travel back to prehistoric times with us! Learn about different dinosaurs and their daily routines when they roamed the earth. A field trip to South Bend Dinosaur Museum to be determined.

Week 4: Wonderful World of Wizardry — 6/23 – 6/27

Calling all wizards! If your child loves the world of magic, they will love jumping into the fantasy world of wizards for this camp. We will create our own wands, be sorted into houses and learn to write with quills!

Week 5: Sports of all Sorts — 6/30 – 7/3, (No Camp 7/4)

Campers can explore different sports and learn what they like or love!

Week 6: The Great Outdoors — 7/7 – 7/11

Take a trip to the great outdoors with us! We'll explore nature and take a minute to appreciate the beauty of the world around us. A field trip to St. Pat's County Park to be determined.

Week 7: Going Wild — 7/14 – 7/18

Calling all animal lovers! Join us for a week of learning about the WILD! Visitors from Potawatomi Zoo to be determined.

Week 8: Decades — 7/21 – 7/25

Dance through the decades with us this week! We'll explore the 60s, 70s, 80s and 90s! Themed clothing is always welcome, but never required.

Week 9: We Are Family — 7/28 – 8/1

Join us for a celebration of our last week of camp! Campers sign "yearbooks" and wish each other well before heading out for the summer!



Navigators Day Camp is held at
Ironworks Event Center, 414 North Hill St.

Need more information?

Email Lauren McGowan at

lauren.mcgowan@mishawaka.in.gov

**Note: No refunds will be given for Navigators Day Camp registrations.*

Spring and Fall Camps

Join us for seasonal fun at our camps! Spring Camp at Merrifield Park features a colorful Cinco de Mayo fiesta with Hispanic games, activities, and a mid-morning snack. Fall Camp at George Wilson Park brings spooky adventures with trail walks, a costume contest, pumpkin carving, and more, plus tasty snacks. Sign up now to be part of the excitement

Spring Camp

Unplug during spring break and join us for an all-out fiesta at Merrifield Park! We will learn about Cinco de Mayo and enjoy traditional Hispanic games and activities. Snack will be provided halfway through the morning.

Date: Tentatively, April 7th – April 11th
Ages: 6 to 10
Cost: \$50
Times: 8:00 am – 12:00 pm
Location: Castle Manor in Merrifield Park

Fall Camp

Join us for a spooky week out at George Wilson Park! We'll walk through the trails, have a costume contest, carve pumpkins, and so much more! Snack will be provided halfway through the morning.

Date: School City of Mishawaka Fall Break
Ages: 6 to 10
Cost: \$50
Times: 8:00 am – 12:00 pm
Location: George Wilson Park



Spring Camp location:
Castle Manor
801 North Indiana Avenue

Fall Camp location:
George Wilson Park
2605 South Clover Road

Need more information?
Email Lauren McGowan at
lauren.mcgowan@mishawaka.in.gov

*Note: No refunds will be given for Spring / Fall Day
Camp registrations.

OPEN

Merrifield Pool

One of the most popular features at the Merrifield Complex is our Olympic-sized pool. The pool offers a safe, supervised, and healthy environment for the members of our community. Among its many amenities are two (2) rock walls, two (2) diving boards, a zipline, and a concession stand. Not comfortable with the water yet, or want to learn new strokes? Check out our learn to swim program!

OPEN PUBLIC HOURS

Lap Swim (Saturday-Sunday)	9:00 am-10:00 am
Open Swim (Monday-Friday).....	12:00-4:00 pm 6:00-8:00 pm
Open Swim (Saturday-Sunday)	1:00-8:00 pm

**Note: The pool will close to the General Public at 4:00 pm on July 4th.*

DAILY ADMISSION RATES

Toddler (2 to 4)	FREE
Youth (5 to 17).....	\$5.00
Adult (18 to 61).....	\$5.00
Senior (62+)	\$5.00
Family (Monday-Friday).....	\$20.00
Re-Entry (6:00-9:00 pm)	\$3.00
Group Rate (10+ people).....	\$4.00
Supervisor (1 required per every 10 people)	\$6.00
Lap Swim.....	\$5.00
Lap Swim Punch Card (12 entries)	\$50.00
Spectator Rate.....	\$3.00
Pool Rental.....	\$150/hr

SEASON PASSES

Youth Resident (5 to 17).....	\$90.00
Youth Non-Resident (5 to 17)	\$140.00
Adult Resident (18 to 61).....	\$100.00
Adult Non-Resident (18 to 61)	\$150.00
Senior Resident (62+)	\$80.00
Senior Non-Resident (62+).....	\$130.00
Family Resident.....	\$150.00
Family Non-Resident	\$230.00

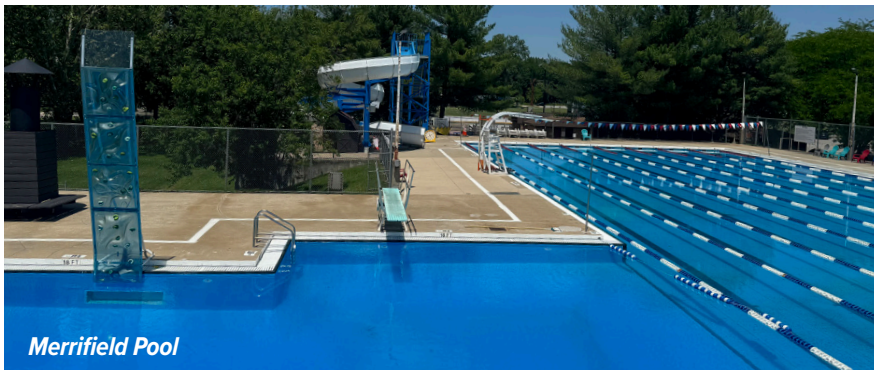

INFO

Opening June 2 Closing August 8

Merrifield Pool is located at:
1000 East Mishawaka Avenue
For more info call (574) 258-1665.

***We request that groups contact us before coming to public swim sessions to help prepare for the larger number of patrons. Group forms are required ahead of time. Please contact us to obtain a copy of the form.*

***Private rentals are required to fill out a Rental Agreement and must pay to hold date and time frame of rental. Please contact us to obtain a copy of the rental agreement.*

Season Passes are not permitted for any special events.

Fees & charges are subject to change without prior notice.

No refunds will be given for Merrifield Pool fees.

Rules

Any juvenile under 18 years of age must be accompanied by a parent or guardian to enter the complex.

No bags allowed outside the locker rooms.

Every patron entering the pool must purchase a photo ID before being permitted to enter the facility.

Each photo ID is valid for two (2) seasons. The photo ID must be presented at each visit.

Photo IDs

Resident.....	\$3.00
Non-Resident	\$15.00

Merrifield Pool

Birthday Party Package

Our birthday party package includes a fenced in area with three picnic tables. Outside food and drinks are allowed in that area; however, no alcohol is permitted. Decorations are permitted for any occasion.

Base Rate.....\$80.00
Entry Fee (per person)..... \$4.00

Swim Lessons

PARENT/CHILD CLASS

6 months to 2 years old. The focus of the parent/child class is on the child feeling comfortable in the water as well as learning safety skills under water.

PRESCHOOL

3 to 5 years old | The focus of the preschool class is on three skill levels that work on the beginning motions of movement in the water as well as safety techniques.

LEARN TO SWIM

5+ years old | The focus of the Learn to Swim class is on six levels that teach basic movement to advanced stroke techniques.

Learn to Swim

Merrifield Pool offers American Red Cross Learn to Swim lessons. We follow their curriculum for eight lessons per session. We keep our class size to five students to one instructor.

Session 1: June 2nd – June 13th
Session 2: June 9th – June 20th
Session 3: July 7th – July 18th
Cost: \$50/session

Times:

Session 1: Learn to Swim – 5:15 – 6:00 pm

Session 2: Learn to Swim – 10:00 – 10:45 am and
11:00 – 11:45 am | Preschool – 11:00 – 11:30 am |
Parent/Child – 11:30 am – 12:00 pm

Session 3: Learn to Swim – 10:00 – 10:45 am & 11:00
– 11:45 am | Preschool – 11:00 – 11:30 am

NOTE: Lessons meet Monday – Friday, equaling eight lessons per session. The first day of each session is divided by skill level. The last Friday of each lesson will be a family swim that allows the participants to show off the new skills they've learned.

BWW Meet with Indiana Swimming

Concord Swim Club is hosting their annual three-day swim meet for multiple competitive swimming clubs from around Indiana at Merrifield Pool.

Dates: May 23rd – May 25th

Neon Glow Swim

Come and enjoy a night of swimming. Bring your family, friends, and your favorite neon apparel for a great night!

Date: July 12th

Cost: Standard admission rates + \$2.00

Times: 8:30 – 11:00 pm

**Note: Season Passes are not permitted*

Cardboard Boat Regatta

Build a boat out of cardboard and duct tape, then come race for prizes. There will be different categories to enter and be judged, like best decorated and best original design. Teams are responsible for all their own supplies.

Date: July 20th

Cost: \$5

Time: 10:00 am

Pooch Plunge

Bring your pooches out for a dip in the pool as the season closes! Must have one adult per pooch. The number of dogs will be limited to 50.

Date: August 11th

Cost: \$10 | \$3 per additional person

Time: 6:00 – 8:00 pm

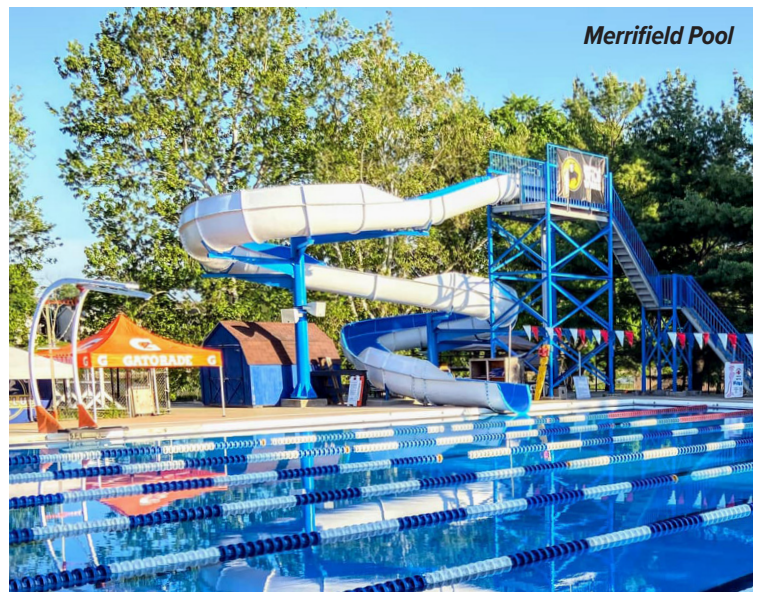

Ironworks Ice Rink

Located in the heart of downtown Mishawaka, this 17,500-square foot ice ribbon and plaza offers daily ice skating, birthday party rentals, skating lessons, unique ice activities, and community events. We are committed to providing the most enjoyable outdoor ice-skating experience accompanied by lively music and colorful changing lights for a memorable ice-skating experience for all ages. The Ironworks Ice Rink is the go-to destination in Mishawaka during the holiday season. Online registration for sessions preferred and can be done at: <https://checkout.roller.app/ironworksplaza/products/booknow#/sessions>.

Ironworks Ice Rink

Winterfest — December 7th

Opening — December 8th

Open Public Hours

We offer multiple 90-minute sessions daily! In between each session, we take a 45-minute break for the Zamboni to resurface the ice rink. We have a reservation only skate facility, to limit the capacity for everyone to enjoy.

Monday Wednesday	5:00 pm 7:15 pm
Tuesday Thursday	5:30 pm 7:45 pm
Friday	4:00 pm 6:15 pm 8:30 pm
Saturday Sunday	11:30 am 1:45 pm 4:00 pm
.....	6:15 pm 8:30 pm

Winter Break Hours

Monday-Sunday

11:30 am | 1:45 pm | 4:00 pm | 6:15 pm | 8:30 pm

**Please note: The rink will be closed on Christmas Eve, Christmas Day, and New Year's Day.*

Admission Rates

Toddler (0 to 4)	FREE
Youth (5 to 17)	\$8.00
Adult (18+)	\$11.00
Field Trip	\$5.00
Rink Rental	\$650.00

Season Passes

Individual	\$90.00
Family	\$200.00

**Season Passes include admission and skate rental*

Bumper Cars

10 minutes	\$10.00
------------------	---------

Icebyks

10 minutes	\$5.00
------------------	--------

Birthday Party

Celebrate your special day with us! Each party session lasts 90 minutes and includes: 20 skate rentals, 5 skate aids, and a birthday shout out. 35 guests maximum.

Cost: \$300



Ironworks Ice Rink

Santa Meet & Greet

Meet the jolly man himself! Meet and greet Santa, where holiday wishes come true and festive cheer is guaranteed. Be on the lookout for more details to come.

Cost: Free

Time: TBD

Skate with Santa

Join Santa for a frosty skate that's sure to warm your heart! Experience the magic of the season with a special ice-skating adventure alongside the jolly man himself!

Date: December 14th

Cost: Standard admission rates

Time: 6:15 – 7:45 pm | 8:30 – 10:00 pm

Grinch Skate

Twirl and whirl with the Grinch this holiday season. Experience ice skating like never before with playful antics and Grinch-approved fun. It's a festive frolic that's sure to bring out your inner Whoville spirit.

Date: December 21st

Cost: Standard admission rates

Time: 6:15 pm



Ironworks Ice Rink

Barbie Night

Skate into a world of glitz and glam with Barbie! Join the dazzling adventure in your best Barbie inspired outfit and let the magic of Barbie make your skating experience fabulous!

Date: January 4th

Cost: Standard admission rates

Time: 6:15 pm

Carnival on Ice

The carnival on ice! Enjoy your favorite carnival games while skating around Ironworks!

Date: January 18th

Cost: Standard admission rates

Time: 8:30 pm

Country Night

Skate to your favorite country hits!

Date: February 7th

Cost: Standard admission rates

Time: 8:30 pm



Ironworks Ice Rink location:
410 North Hill Street

For more information: (574) 208-5552

Season Passes are not permitted for any special events.

Fees & charges are subject to change without prior notice.

No refunds will be given for Ironworks Ice Rink fees.

Eberhart-Petro Golf Course

Eberhart-Petro Municipal Golf Course has been a Mishawaka treasure since 1929. Originally a 9-hole course along the south side of the St. Joseph River, it expanded to 18 holes in 1949, featuring four river crossings. Known for its pristine condition and challenging design, this 6,000-yard, par-70 course is one of the toughest in the Midwest. Spanning just 89 acres, it offers a test for golfers of all skill levels. Experience one of Mishawaka's finest assets today!

Season Pass Fees

Junior Resident (7 to 22 with valid College I.D.)	\$265.00
Junior Non-Resident (7 to 22 with valid College I.D.)	\$305.00
Adult Resident (Ages 18 to 61)	\$645.00
Adult Non-Resident (Ages 18 to 61)	\$845.00
Adult Couple Resident (Ages 18 to 61)	\$755.00
Adult Couple Non-Resident (Ages 18 to 61)	\$985.00
Family Resident (those claimed on Federal 1040)	\$815.00
Family Non-Resident (those claimed on Federal 1040)	\$1,025.00
Senior Resident (62+ and fully retired)	\$525.00
Senior Non-Resident (62+ and fully retired)	\$720.00
Senior Couple Resident (62+ and fully retired)	\$585.00
Senior Couple Non-Resident (62+ and fully retired)	\$815.00

Daily Fees

9 holes (Monday-Friday)	\$18.00
18 holes (Monday-Friday)	\$24.00
Weekend/Holiday (9 or 18 holes)	\$26.00
Weekend (9 or 18 holes after 12:00 pm)	\$16.00
Twilight (Monday-Friday 9 or 18 holes after 4:00 pm)	\$13.00
League Fees (9 or 18 holes)	\$16.00
Senior (Monday-Friday 9 or 18 holes 62+)	\$16.00
Outing Rate (per person, including cart)	\$40.00

Miscellaneous Fees

Cart (9 holes)	\$10.00
Cart (18 holes)	\$20.00

Fall Special:

18 holes (with half cart)	\$36.00
18 holes (walk)	\$16.00
Pull Cart (9 holes)	\$2.00
Pull Cart (18 holes)	\$3.00

SUMMER PROGRAMS

June and July – Summer Junior Golf Club

This junior program is a detailed and in-depth learning process for kids wanting to expand their game in all facets of golf. It also covers how golf is a reflection and teaching of life skills. This program is a seven-week session, taking place every Wednesday morning in June and July around 8:00 am. It will last about an hour each session and costs \$85.00 per child for the whole summer.

Dates: June 11th – July 30th

Mishawaka Men's Metro

Come join us for Mishawaka's annual flagship tournament, the Mishawaka Men's Metro. This long-standing event is the pinnacle of the golf season, so don't miss out! There will be 36 holes of stroke play (18 each day) on June 28th and 29th. After 36 holes, we will make a cut to the top 3 scores plus ties in each flight to play in the final round. The final round will be played on July 5th where we will crown a new Mishawaka Men's Metro champion and Senior Men's Metro champion. Stop by the pro shop to enter today!

Dates: June 28th – 29th, July 5th

July – Garbage Open

This is the flagship junior golf tournament that put Eberhart-Petro on the golfing map over 65 years ago. It has been, and will always be, a FREE tournament for the kids, with food and drinks following the event. For generations of golfers in Mishawaka, when they think of Eberhart, they think of the Garbage Open.

Date: July 16th

All Season – Golf Outings

Eberhart-Petro is home to multiple Golf Outings throughout the season; please check with the Pro Shop for more details. This is the ultimate outing golf course! With a beautiful river setting and pristine conditions, the course provides an excellent backdrop for your company or organization. Book your outing with us and show your customers a wonderful day on this extravagant golf course to be enjoyed by everyone.



Eberhart-Petro Golf Course location:
801 North State Street

For more information
(574) 255-5508

Fees and charges are subject to change without prior notice.

George Wilson Park

Named after a Mishawaka High School athletic coach in the 1950s-1960s, the park features 54.3 acres of rolling hills, lush tall trees, a playground and scenic views of Mishawaka and South Bend. In 1990, the disc golf course was installed, which hosted the 1996 PDGA Disc Golf World Championships and continues to host several disc golf tournaments throughout the year. The park also hosts excellent snow tubing hills for the winter months, its signature 55' teepee-like windbreak structure overlooks the park, while providing shelter from the bitter cold winter weather. The warming shelter features a gas fireplace, concession items and restrooms. Visit George Wilson Park and get back in touch with nature today!

TUBING HILL

Experience the thrill of winter at the George Wilson Park Winter Tubing Hill! Perfect for all ages, this snowy adventure offers a fun-filled day of tubing down our exciting slopes. Bring your family and friends to enjoy the crisp winter air and create unforgettable memories. Affordable pricing and a cozy warming area make it a must-visit destination this season. Don't miss out on the coolest way to slide into winter!

Hours of Operation..... 10:00 am – 8:00 pm
November through March, daily (weather dependent)

Daily Admission Rates

Admission.....	\$4.00
Group Rate.....	\$2.00
Tube Rental.....	\$3.00

**Group fee is per person; must have 10 or more people, with a supervisor, for every 10 children.*

NO SLEDS, SNOWBOARDS OR TOBOGGANS ARE ALLOWED. INFLATABLE TUBES ONLY!

Taking a Group to the Hill?

Groups are always welcome at the park; however, to ensure safety, we ask those wishing to bring groups to contact the Park Office regarding the intended date. This will assist us in properly staffing your event for the day.



Tubing Hill at George Wilson Park

DISC GOLF

Looking for a fun and active way to enjoy the great outdoors? Visit the Disc Golf Course at George Wilson Park! Whether you're a seasoned pro or new to the game, our beautifully maintained course offers a challenge for all skill levels. Nestled in a scenic setting, it's the perfect spot for a solo round or a friendly competition with friends and family. Grab your discs and join us for an unforgettable day of fun and fresh air!



Disc Golf at
George Wilson Park

Hours of Operation..... Sunrise to Sunset
January through December, daily (weather dependent)

Daily Admission Rates

Admission.....	\$4.00
Group Rate.....	\$2.00

Miscellaneous Fees

Disc Purchase	\$8.00 – \$20.00
Disc Golf Tournament (Park Rental)	\$200.00

Season Passes

Adult.....	\$45.00
Junior (16 & under)	\$20.00

Season Passes available for purchase online at:
<https://mishawaka.recdesk.com/Community/Membership>

ALL DOGS MUST BE HELD ON A LEASH AND WASTE DISPOSED OF PROPERLY! PLEASE RESPECT THE COURSE AND ALL PARK VISITORS.



George Wilson Park location:
2605 South Clover Road
(1 mile west of Indiana 331 on Dagoon Trail)
Admission Hut: (574) 258-1707

**Note: Fees and charges are subject to change without prior notice.*

Battell Community Center

BCC is dedicated to providing organized programming for the development of our children and teens; activities and services for adults and senior citizens; and affordable recreational, social, and educational activities to community members of all ages.

ADULT FITNESS

Battell Community Center Fitness Room

Check out our new and improved Fitness Room on the first floor! The Fitness Room offers treadmills, ellipticals, and several recumbent machines. To sign up, stop by the front desk in the lobby at Battell Center for registration forms.

Hours of Operation

Monday – Thursday 9:00 am – 9:00 pm

Friday 9:00 am – 5:00 pm

Ages: 18+

Cost: Resident \$10/month | Non-Resident \$15/month

Open Gym

Open gym takes place at the Battell Community Center gym. Open gym will be closed occasionally due to facility rentals, holidays, or special events. Participant waivers must be completed before being able to participate in an open gym. All participants must be checked in at the receptionist desk before entering the gym. Children must be accompanied by an adult.

Dates: Pre-K & Toddler, Thursdays | Children 10+, Wednesdays & Thursdays

Cost: Free

Time: Pre-K & Toddler: 9:00 – 11:00 am | Children 10+: 2:30 – 4:30 pm

Location: Battell Community Center

Middle Eastern Dance

Fitness and fun for all ages! Classes run January through December. For cost and information, contact Ruby at (574) 315-1915.

Level 1: Wednesdays, 6:00 – 7:00 pm

Level 2: Wednesdays, 7:15 – 8:15 pm

Level 3: Mondays, 6:00 – 7:30 pm

**Level 1 is for beginner belly dancers. Level 2 is for intermediate and advanced belly dancers. Level 3 must be approved by Ruby to attend.*

Cardio Drumming

Missy's Cardio Drumming class combines dance and fitness making this a fun and healthy activity for everybody! All skill levels are welcome and challenged. During the winter months, all classes are blacklight – or glow parties!

Dates: Mondays | Tuesdays | Thursdays

Cost: \$5/class

Time: Mondays, 6:30 pm | Tuesdays & Thursdays, 7:00 pm

Location: Battell Community Center

Karate Classes

McCreery Karate Classes involve learning many forms and techniques, in both styles of Kyokushin and Shorin Ryu. Martial Arts help with coordination, balance, and overall physical wellness. Students will learn self-discipline, respect, and focus. All ages are welcome. Instructor will help you attain a uniform. Steve McCreery has 32 years of martial arts experience. His students currently range from ages 5 – 70.

Beginner Karate

Perfect for newcomers, this class introduces the fundamentals of karate, including basic stances, punches, and kicks, while building confidence, coordination, and discipline.

Dates: Mondays | Tuesdays

Ages: 5 to 8

Cost: \$65/month

Time: 6:00 – 6:30 pm

Location: Battell Community Center

Fees and charges are subject to change without prior notice.

Advanced Karate

Students will challenge their physical and mental skills, working towards mastery under the guidance of skilled instructors.

Dates: Mondays | Tuesdays

Ages: 9+

Cost: \$65/month

Time: 6:30 – 7:30 pm

Location: Battell Community Center



Battell Community Center
is located at:
904 North Main Street

Fees and charges are subject to change without prior notice.

Rec Clubs – Free and For All Ages

*Battell Community Center hosts many recreational activities and groups for people of all ages.
Activities offered are free to patrons and occur year-round.
For more information, contact the Park Office at (574) 258-1664 ext. 1*

Pastels

Join this group if you enjoy working independently on your artwork. Bring your own supplies and be ready to have fun and socialize.

Tuesdays, 12:00 – 3:00 pm

Aerobics

Join this group for a great morning exercise routine to start your day!

Monday & Wednesday, 9:00 – 10:00 am

Euchre

All are welcome to attend.

Monday, 6:00 – 9:00 pm | Thursday, 1:00 pm

Ping Pong

Need a little exercise? Come down to Battell Center Gym for an afternoon of ping pong.

Tuesday & Friday, 1:00 – 4:00 pm

Real Services' Nutrition Site

The Nutrition Site at Battell serves lunch in the Community

Room. The suggested donation is \$4.25 for seniors, and it isn't so much a cost as a suggested donation. All contributions are happily accepted. Lunch is offered at \$8.25 for those under 60. Reservations MUST be made one day in advance by calling (574) 256-2325.

Open Monday through Friday.
Daily, 11:30 am



Senior Shape-up

All exercises are done while sitting in a chair or standing near the chair.

Monday, Wednesday, & Friday, 10:15 – 11:15 am



Battell Community Center

Battell Center Facility Rental

Are you looking for a room to hold a bridal shower, business meeting, or holiday party? Or maybe you need a space for a concert, birthday party, or musical performance? The Battell Community Center has facility rental spaces for you! We have meeting rooms that can hold up to 50 people, the Community Room with kitchen access, and an Auditorium with over 400 seats, which are all available for rent.

ROOM RENTALS



Battell Community Center – Community Room

Community Room

Capacity: 65
Fees: Monday – Friday – \$35/hour | Saturday – Sunday – \$300/day
Amenities: Kitchen Facility, Table and Chairs

Voorheis Room

Capacity: 40
Fees: Monday – Friday – \$25/hour | Saturday – Sunday – N/A
Amenities: Refrigerator, Microwave, Coffee Maker, Tables and Chairs

Lions Room

Capacity: 40
Fees: Monday – Friday – \$25/hour | Saturday – Sunday – N/A
Amenities: Refrigerator, Microwave, Coffee Maker, Tables and Chairs

Wagle Room

Capacity: 40
Fees: Monday – Friday – \$25/hour | Saturday – Sunday – N/A
Amenities: Tailgater Bluetooth Speaker

Aerobics Room

Capacity: 25
Fees: Monday – Friday – \$25/hour | Saturday – Sunday – N/A
Amenities: Tailgater Bluetooth Speaker

Centennial Room

Capacity: 25
Fees: Monday – Friday – \$25/hour | Saturday – Sunday – N/A
Amenities: Tailgater Bluetooth Speaker

Dance Studio

Capacity: 20
Fees: Monday – Friday – \$25/hour | Saturday – Sunday – N/A
Amenities: Tailgater Bluetooth Speaker

Gymnasium

Capacity: 200
Fees: Monday – Friday – \$60/hour | Saturday – Sunday – \$250/0 – 4-hours, \$350/4 – 8 hours
Amenities: Tailgater Bluetooth Speaker

Party Packages

Community Room with 0-2 hours Gym Rental \$400
Community Room with 2-4 hours Gym Rental \$450
Community Room with 4-6 hours Gym Rental \$500
Community Room with 6-8 hours Gym Rental \$550



Battell Community Center
is located at:
904 North Main Street

Fees and charges are subject to change without prior notice.

Additional fees may be required.

Battell Center Facility Rental

AUDITORIUM RENTALS

A. Half Day

6 hours including setup and tear down.

8:00 am – 2:00 pm or 3:00 – 9:00 pm

For Profit Usage\$400.00

Not-For-Profit Usage\$200.00

B. Full Day

13 hours including setup and tear down.

8:00 am – 9:00 pm

For Profit Usage\$500.00

Not-For-Profit Usage\$250.00

C. One Performance with 5 Day (M-F) Rehearsal

Base fee. Access to auditorium for rehearsals during business hours.

For Profit Usage\$1,250.00

Not-For-Profit Usage\$625.00

D. One Performance with 10 Day (M-F) Rehearsal

Base fee (same inclusions and additional costs as C. above.)

For Profit Usage\$2,000.00

Not-For-Profit Usage\$1,000.00

E. Additional Performances added to Options C – D

Base fee (same inclusions and additional costs as C. above) per single performance.

For Profit Usage\$400.00

Not-For-Profit Usage\$200.00

F. Additional Room Use

Day of performance: added to option A – E.

Fee is applied per room, per day.

For Profit Usage\$35.00

Not-For-Profit Usage\$35.00

*Fees and charges are subject to change without prior notice.
Additional fees may be required.*



Battell Community Center – Auditorium

Park Pavilion Rentals

Pavilions at parks listed below must be reserved and permitted to use for any planned event.
Rental season runs from April 15th – October 15th. Pavilions are rented per day from 10:00 am – 9:00 pm.

Payment and rental application are due in full at the time of reservation, no exceptions.
Payment can be made by cash, check or credit/debit card. To reserve a park pavilion, contact the
Parks and Recreation Office, (574) 258-1664 ext. 1 or email parks@mishawaka.in.gov.

Bendix Park	340 South Delorenzi Avenue
Capacity: 70	Fees: \$90

Amenities: Basketball Court, Fishing Access/Pier, Flat Field, Lake/River, Grills, Picnic Area, Playground, Restrooms, Shelter

Central Park – Large	235 East Mishawaka Avenue
Capacity: 100	Fees: \$175

Amenities: Fishing Access/Pier, Fitness Court, Grills, Pickleball Courts, Picnic Area, Playground, Restrooms, Shelters, Splash Pad, Tennis Courts

Central Park – Ballband, Bendix, Dodge, Wheelabrator	235 East Mishawaka Avenue
Capacity: 40	Fees: \$125

Amenities: Fishing Access/Pier, Fitness Court, Grills, Pickleball Courts, Picnic Area, Playground, Restrooms, Shelters, Splash Pad, Tennis Courts

Crawford Park - Sycamore	445 Niles Avenue
Capacity: 40	Fees: \$90

Amenities: Grills, Picnic Area, Playground, Restrooms, Shelter, Splash Pad

Henry Frank Park	731 East Day Road
Capacity: 50	Fees: \$90

Amenities: Ball Field, Basketball Court, Grills, Picnic Area, Playground, Restrooms, Riverwalk/Trail, Shelter

Heroes Park	3110 Harrison Road
Capacity: 50	Fees: \$90

Amenities: Basketball Court, Checkers Table, Cornhole Boards, Flat Fields, Gaga Pit, Grills, Hammock Station, Ninja Warrior Course, Picnic Area, Ping Pong Tables, Playground, Restroom, Shelter, Sand Volleyball

Hillis Hans Park	601 East 13th Street
Capacity: 30	Fees: \$90

Amenities: Basketball Court, Grills, Picnic Area, Playground, Restrooms, Shelter

Margaret Prickett Park	13240 Jefferson Boulevard
Capacity: 100	Fees: \$90

Amenities: Boat Launch, Fishing Access/Pier, Grills, Off-Leash Dog Park, Picnic Area, Restrooms, Shelter

Mary Gibbard Park	1024 Somerset Avenue
Capacity: 100	Fees: \$125

Amenities: BMX Bike Course, Grills, Picnic Area, Playground, Public Library, Restrooms, Riverwalk/Trails, Shelter, Soccer Fields, Splash Pad

Merrifield Park – Grey Wolf, Princess Mishawaka, Scout Deadshot	1000 East Mishawaka Avenue
Capacity: 40	Fees: \$125

Amenities: Grills, Playground, Restrooms, Riverwalk/Trails, Shelter

Normain Park*	200 East McKinley Road
Capacity: 100	Fees: \$90

Amenities: Ball Fields, Basketball Court, Grills, Historic Site, Picnic Area, Playground, Restrooms, Shelter, Sand Volleyball

*Not reserving for the 2025 season.

Rose Park – DeAmicis*	1501 South West Street
Capacity: 40	Fees: \$90

Amenities: Grills, Picnic Area, Playground, Restrooms, Shelter, Splash Pad

*Additional amenities to come.

Temple Park	501 East Edgar
Capacity: 40	Fees: \$90

Amenities: Basketball Court, Gazebo, Grills, Picnic Area, Playground, Restrooms, Shelter

Twin Branch Park – Bicentennial	3900 Lincolnway East
Capacity: 100	Fees: \$125

Amenities: Basketball Court, Cornhole Boards, Grills, Picnic Area, Pickleball Courts, Ping-Pong Tables, Playground, Restrooms, Shelter, Soccer Fields, Splash Pad

Twin Branch Park – Mullins	3900 Lincolnway East
Capacity: 30	Fees: \$90

Amenities: Basketball Court, Cornhole Boards, Grills, Picnic Area, Pickleball Courts, Ping-Pong Tables, Playground, Restrooms, Shelter, Soccer Fields, Splash Pad

Non-Profit – All pavilions except for Central Park, Mary Gibbard Park, Merrifield Park, and Twin Branch	Fee: \$65/day
--	----------------------

Fees and charges are subject to change without prior notice.
Additional fees may be required.

Outdoor Rentals

Looking for a place to hold your wedding ceremony, host a festival or a 5K? The Battell Bandshell, Beutter Park, Central Park, and Kamm Island may be reserved April 15th – October 15th for your public event needs. Each location is always still open to the public during the event (some exceptions do apply). Note: Additional fees may be associated with Public Events. To rent one of these facilities or for more information, contact the Mishawaka Parks & Recreation Office, (574) 258-1664 ext. 1 or email parks@mishawaka.in.gov.



Battell Park Bandshell

Battell Bandshell

Address: 301 West Mishawaka Avenue
Fees: \$100/day | Non-Profit: \$65/day

Included in Rental: Bandshell and Cement Pad in Front

Battell Rock Garden/Gazebo

Address: 301 West Mishawaka Avenue
Fee: \$100/2-hours

Included in Rental: Rock Garden/Gazebo

Beutter Park

Address: 120 Ironworks Avenue
Fee: \$225/2-hours

Included in Rental: Stage Area

Beutter Park, [non-wedding/non-run/walk]

Address: 120 Ironworks Avenue
Fees: \$550/day | Non-Profit: \$350/day

Included in Rental: Stage Area

Beutter Park, [Riverwalk-Run/Walk]

Fees: \$300/4-hours | Non-Profit: \$200/4-hours

Included in Rental: Riverwalk

Central Park

Address: 235 East Mishawaka Avenue
Fees: \$1,000/day | Non-Profit: \$750/day

Included in Rental: All five (5) pavilions

Central Park Stage

Fees: \$300/2-hours | Non-Profit: \$200/2-hours

Included in Rental: Stage Area

Kamm Island

Address: 600 West Front Street
Fees: \$1,200/day | Non-Profit: \$900/day

Included in Rental: Island

Kate's Garden

Address: 1122 Lincolnway West
Fee: \$75/2-hours

Included in Rental: Gazebo

Shiojiri Garden

Address: 450 Niles Avenue
Fee: \$150/2-hours

Included in Rental: Seating for twelve (12) included in gazebo. Due to being an ornamental garden, additional chairs are not permitted – standing room only.

*Fees and charges are subject to change without prior notice.
Additional fees may be required.*



Kate's Garden

Ball Field and Building Rentals

SOFTBALL FIELD RENTALS

Ball fields may be reserved April 15th – October 15th for your practice or game. Use of bases and lights are not included in rental of fields. To rent a ball field, contact the Mishawaka Parks & Recreation Office, (574) 258-1664 ext. 1 or email parks@mishawaka.in.gov.

HENRY FRANK

731 East Day Road

Fee: \$20

Fields are reserved for practice purposes only. Leagues, games and/or tournaments must be approved prior to reserving by the

BUILDING RENTALS

The Mishawaka Parks Department has three (3) indoor facilities for your event needs. Castle Manor, Eberhart-Petro Golf Course Clubhouse, and the Ironworks Event Center. Castle Manor and the Ironworks Event Center are available year-round, while the Eberhart Clubhouse is available April 1st – October 1st. For more information or to rent Castle Manor or the Ironworks Event Center, contact the Parks and Recreation Office, (574) 258-1664 ext. 1 or email parks@mishawaka.in.gov. For more information or to rent the Eberhart-Petro Golf Course Clubhouse, contact the Pro Shop at Eberhart, (574) 255-5508 or email aroop@mishawaka.in.gov.

Castle Manor

Address: 801 Indiana Avenue

Capacity: Inside, 75 | Inside & Patio, 120

Fee: \$400/day

Amenities: One (1) Standard Refrigerator, One (1) Electric Stove, One (1) Heat Rack, Gas Fireplace or furnace available, Air Conditioned, Restrooms, Playground, Tables, Chairs

Castle Manor and Grey Wolf Pavilion Combo

Fee: \$475/day

Eberhart Clubhouse

Address: 801 North State Street

Capacity: 100

Fee: \$500/day

Amenities: Tables, Chairs, Restrooms, Golf Course (additional fees do apply for use of the golf course)

Ironworks Event Center

Address: 414 North Hill Street

Capacity: 128

Fee: Monday – Thursday, \$800/day | Friday – Sunday, \$1,000/day

Amenities: Wireless internet, Projector Screen, Indoor Sound System with Microphone, Onsite Parking, Restroom, Tables, Chairs



Ironworks Event Center



Ironworks Event Center

*Fees are subject to change without prior notice.

*Additional fees may be required.

Adopt-A-Park Program

MISSION

Our Adopt-A-Park Program is designed to get individuals, organizations, and local churches involved in the beautification of our wonderful park system. For many years, we have partnered with local groups to promote the idea of community stewardship of our parks through planting projects, mulch events, general clean-up activities, and much more. If you are interested in becoming involved in our Parks, we are happy to find an activity that suits you or your organization.

HOW CAN I GET INVOLVED?

Anyone from an individual or a community minded organization can become involved in the Adopt-a-Park program. By participating, individuals, neighborhood organizations, park users, civic and church groups, families, scout troops, businesses, youth groups and schools are all encouraged to do what they can to promote safe, beautiful places for residents to enjoy. Some of the main supporters were:

Some of the main supporters were:

- PHM Middle Schools
- Epic Church
- St. Joe Valley Master Gardeners
- Summer of Service
- The Vineyard Church
- Mishawaka High School Garden Club

AREAS TO ADOPT

You can adopt an entire park or a particular area in a park including:

- Flower Beds
- Playgrounds
- Picnic Shelters & Band Shell
- Trails
- Trees & Shrubs
- Sidewalks

HOW CAN ORGANIZATIONS HELP?

Volunteer groups can help care for their adopted areas in the following ways:

- Litter pick-up
- Leaf raking and debris removal (dead grass, tree limbs, vegetation, wind debris)
- Spreading of mulch, gravel, playground fiber
- Removal of exotic invasive plants
- Assisting staff with planting of flowers, shrubbery, maintenance of flower beds (including weeding and watering)
- Clean-up of picnic shelters and play structures
- Helping to take an inventory of our Park and Public Trees
- Other improvement ideas as suggested or approved

WAYS FOR INDIVIDUALS TO HELP

We are always looking for ways to engage with individuals, families, or small groups and the perfect opportunity to do so is right alongside our Landscape Staff! Each week our Landscape Staff is committed to beautifying Beutter Park, The Ironworks Mill Plaza, and Central Park. We also will be offering options to assist with the care of the Mishawaka Education Foundation Community Greenhouse and surrounding gardens at the Battell Community Center year-round. Individuals that wish to work alongside our amazing staff are welcome to join up at any time without commitment. This year we will be offering complimentary prizes and incentives for volunteers that log hours with our staff. All volunteers will get a complimentary Parks Volunteer T-Shirt and there will be other incentives and prizes for our most dedicated volunteers.

- Join Landscape Staff on **Wednesdays at Beutter Park** from 7:30 am-2:00 pm, May – September
- Join Landscape Staff on **Thursdays at Central Park** from 7:30-11:00 am, May – September
- Join Landscape Staff at the MEF Community Greenhouse year-round to assist with planting, transplanting plants, and tending to all the wonderful plants that make it out into our wonderful parks.



For more information on adopting a park, contact the Mishawaka Parks Department Office at (574) 258-1664 ext. 4 or email Jake Crawford at jcrawford@mishawaka.in.gov

KEEP MISHAWAKA BEAUTIFUL DAY WITH EPIC CHURCH

Keep Mishawaka Beautiful Day with Epic Church is an opportunity for you or your organization to take an active role in making our parks and green spaces look incredible for the year. Join the Parks Department and Epic Church for an epic day of mulching, cleaning, and planting from 9:00 am – 12:00 pm at Central Park. For more information on how to become involved or register with your organization, contact the Mishawaka Parks Department at (574) 258-1664 ext. 4 or email Jake Crawford at jcrawford@mishawaka.in.gov.

Dates: April 19th | Back-up rain-date April 26th
Time: 9:00 am
Location: Central Park

Off-Leash Dog Run

- Year Round Run Hours: Dawn to Dusk
- **Owners are legally responsible for their dogs and any injuries caused by them.** This run is not patrolled on a regular basis. By entering the Off-Leash Dog Run, you acknowledge that the City is not responsible for the safety of your pet, person, or property.
- Although the City has tried to provide a secure fenced facility, owners should be aware that the perimeter fence is not monitored on a regular basis for holes dug by animals or other accidental damage or wear that may cause a breach in security. Please report the damage.
- To report problems during normal business hours, contact the City of Mishawaka Parks Department at (574) 258-1664. After hours, leave a message or e-mail parks@mishawaka.in.gov. In case of an emergency - Dial 911.
- All dogs must be properly licensed per the City of Mishawaka Municipal Code, inoculated and healthy. To obtain a license, please contact the City of Mishawaka Controller's Office at (574) 258-1622 or the Humane Society.
- All dogs must always wear a collar and ID tags.
- Owners must clean up after their dogs. Failure to pick up after your dog could lead to the closure of the dog run. This run relies on the contributions from patrons for clean plastic bags to pick up waste. Please contribute by depositing clean bags in the labeled container.
- Dogs showing aggression towards people or other animals are not allowed in the run.
- Puppies using the run must be at least four months old.
- Owners should not leave their dog(s) unattended or allowed out of sight.
- We recommend that young children not enter the run. Children in the dog run should be under constant adult supervision.
- Dogs in heat are not allowed inside the run.
- Owners must always carry a leash. Dogs should be leashed before entering and prior to leaving the park.
- The restrooms (including any water supply) provided for this facility is seasonal and is not available on a year-round basis. Owners are encouraged to bring water from home when water is not available.
- Violators will be subject to fines and penalties as permitted by law. Repeated violators could be subject to a suspension of park privileges. We encourage patrons to remind other patrons of the obligations contained herein.
- Repeated problems could also lead to the closure of the Off-Leash Dog Run for everyone.



OPEN

The Off-Leash Dog Run is located at:
Margaret H. Prickett Marina Park
13240 East Jefferson Road,
Mishawaka, IN 46544

Small dog park area available for dogs
15" and below at the shoulder.



Parks Foundation

Mission:

Engaging the community to benefit the Mishawaka Parks and Recreation in order to further the charitable and educational programs and projects of the city.

The long-term goal of the Parks Foundation is to support the development of neighborhood parks through grants, amenity-specific fundraising campaigns, and individual community support.

Social Media

Like us on Facebook:

@mishawakaparksfoundation

Follow us on Instagram:

@mishawakaparksfoundation

Educators Sculpture Project

The Educators Sculpture Project is an opportunity for you to make your mark in Mishawaka, and, if you wish, to honor an educator who made a difference. You can order an engraved brick that will be placed in the brick walkway at the site of the sculpture. Show everyone that YOU care about ART, about MISHAWAKA, and about EDUCATORS!

Make Your Mark in Mishawaka – Permanently!

Each brick costs only \$250.00 – a small price to pay to leave your imprint at one of the most beautiful sites in Mishawaka. And, as a special incentive for current students (grades K through 12), a brick can be purchased for only \$100.00. This is a great way for a class or club to honor a special teacher!

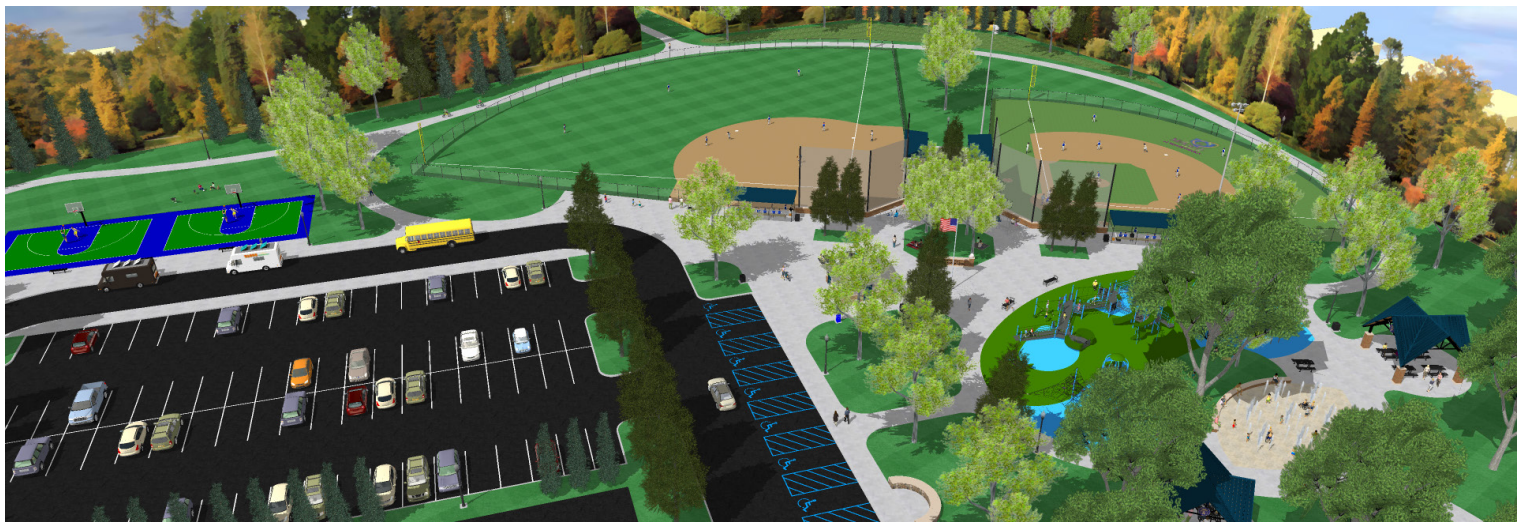

Park Amenities

Explore Our Parks! Discover the beauty and diversity of our 28 parks, offering acres of scenic trails, picnic areas, sports fields, playgrounds, and more! Whether you're looking for a peaceful nature escape or a spot for family fun, our parks provide something for everyone. Check out the full list below to find your next adventure, complete with acreage and amenities to suit your needs.

Ball Band Memorial Park

111 West Mishawaka Avenue
Acreage: 0.73
Amenities: Historic Site, Public Art

Battell Park

301 West Mishawaka Avenue
Acreage: 11.16
Amenities: Gardens, Historic Site, Picnic Area, Playground, Public Art, Restroom, Riverwalk/Trail, Splash Pad, Tennis Courts

Bendix Park

340 South Delorenzi Avenue
Acreage: 34.79
Amenities: Basketball Court, Fishing Access/Pier, Flat Fields, Grills, Horseshoe, Lake/River/Picnic Area, Playground, Restroom, Shelter

Borley Park

1110 East Borley Avenue
Acreage: 2.41
Amenities: Basketball Court, Playground

Central Park

235 East Mishawaka Avenue
Acreage: 13.68
Amenities: Fishing Access/Pier, Fitness Court, Grills, Pickleball Courts, Picnic Area, Playground, Restrooms, Shelters, Splash Pad

Crawford Park

445 Niles Avenue
Acreage: 11.81
Amenities: Grills, Picnic Area, Playground, Restrooms, Shelter, Splash Pad

Eberhart-Petro Golf Course

801 North State Street
Acreage: 89.10
Amenities: Golf Course

George Wilson Park

2605 Clover Road
Acreage: 54.30
Amenities: Disc Golf Course, Picnic Area, Playground, Restroom, Winter Snow Tubing

Henry Frank Park

731 East Day Road
Acreage: 11.85
Amenities: Ball Field, Basketball Court, Disc Golf, Grills, Picnic Area, Playground, Restroom, Riverwalk/Trail, Shelter

Heroes Park

3110 Harrison Road
Acreage: 6.77
Amenities: Basketball Court, Checkers Table, Cornhole Boards, Flat Fields, Gaga Pit, Grills, Hammock Station, Ninja Warrior Course, Picnic Area, Ping Pong Tables, Playground, Restroom, Shelter, Sand Volleyball

Hillis Hans Park

601 East 13th Street
Acreage: 5.20
Amenities: Basketball Courts, Grills, Picnic Area, Playground, Restroom, Shelter

Honor Park

2401 Normandy Drive
Acreage: 0.01
Amenities: Historic Site, Public Art

Hydro Dam Park

215 Power Drive
Acreage: 9.33
Amenities: Fishing Access/Pier, Restroom

Kamm Island Park

600 West Front Street
Acreage: 6.65
Amenities: Picnic Area, Riverwalk/Trail

Park Amenities

Explore Our Parks! Discover the beauty and diversity of our 28 parks, offering acres of scenic trails, picnic areas, sports fields, playgrounds, and more! Whether you're looking for a peaceful nature escape or a spot for family fun, our parks provide something for everyone. Check out the full list below to find your next adventure, complete with acreage and amenities to suit your needs.

Kate's Garden

1122 Lincolnway West
Acreage: 2.48
Amenities: Gardens, Picnic Area, Public Art, Riverwalk/
Trail

Laing Park

2749 Lincolnway East
Acreage: 2.76
Amenities: Fishing Access/Pier

Lincoln Park

1004 Lincolnway West
Acreage: 1.17
Amenities: Boat Launch, Public Art, Restroom,
Riverwalk/Trail

Margaret Prickett Park/Marina

13240 East Jefferson Road
Acreage: 9.46
Amenities: Boat Launch, Fishing Access/Pier, Grills, Off-
Leash Dog Park, Picnic Area, Restroom, Shelter

Mary Gibbard Park

1024 Somerset Street
Acreage: 4.30
Amenities: Grills, Picnic Area, Playground, Public
Library, Restrooms, Riverwalk/Trails, Shelter, Soccer
Fields, Splash Pad

Merrifield Park

1000 East Mishawaka Avenue
Acreage: 16.00
Amenities: Boat Launch, Fishing Access/Pier, Flat
Fields, Grills, Picnic Area, Playground, Restroom,
Riverwalk/Trail, Swimming Pool

Miami "Monkey" Island

801 North State Street
Acreage: 1.76
Amenities: Boat Launch, Historic Sites, Fishing Access/
Pier, Picnic Area

Normain Park

200 E. McKinley Road
Acreage: 7.73
Amenities: Ball Field, Basketball Court, Grills, Picnic
Area, Playground, Public Art, Restroom, Shelter, Sand
Volleyball

Robert C. Beutter Memorial Park

120 Ironworks Ave.
Acreage: 2.91
Amenities: Ball Band Biergarten, Event Center, Fishing
Access/Pier, Ice Skating, Picnic Area, Public Art,
Riverwalk/Trail

Rose Park

1501 South West Street
Acreage: 17.30
Amenities: Grills, Picnic Area, Playground, Restrooms,
Shelter, Splash Pad

Shiojiri Niwa Garden

450 Niles Avenue
Acreage: 1.21
Amenities: Gardens, Public Art

Temple Park

501 East Edgar
Acreage: 3.44
Amenities: Basketball Court, Grills, Picnic Area,
Playground

Twin Branch Park

3900 Lincolnway East
Acreage: 12.00
Amenities: Basketball Court, Cornhole Boards, Grills,
Picnic Area, Pickleball Courts, Ping-Pong Tables,
Playground, Restrooms, Shelters (2), Soccer Fields,
Splash Pad

Sponsorship Opportunities

Is your business or organization looking for an opportunity to market to people who are active, health-conscious, or love the outdoors? The Mishawaka Parks and Recreation Department has a wide range of sponsorship and advertising opportunities that will help you reach your target audience.

Whether you want to reach the parents of children who play sports or people who stay connected to the

City of Mishawaka by participating in special events, you can share your message with locals by teaming up with Mishawaka Parks and Recreation Department. Sponsorship opportunities range from: sponsoring a child to play a sport; placing your logo on the back of t-shirts; gym and field signage; and so much more. Your sponsorship contributions help us achieve our goal of making the Mishawaka the "Best Hometown in America."



HealthMarkets Insurance Agency
Health | Medicare | Life | Supplemental

Dan Blacketor
Licensed Insurance Agent



UNITED PETFOOD



Want more information on
sponsoring the parks?

Reach out to Lauren McGowan at
lauren.mcgowan@mishawaka.in.gov

General Information

Each activity shall have an Originating Document, such as a registration form, contract, information sheet, permit, etc. Such forms shall contain relevant activity information, an acknowledgment, a release of liability, and a refund policy.

To facilitate a refund, the person to whom the original receipt was issued must complete a Request for Refund Form bearing their name, address, and signature. The original receipt must accompany the Request for Refund. Any refund issued will be made payable to the person whom the original receipt was issued. Refunds take approximately four (4) to six (6) weeks, will be made by check only, and will be mailed to the address of the person listed on the Request for Refund Form. We do not provide cash/credit refunds.

Recreation & Activities

- Refunds will not be offered or provided for the following:
- Season Passes (other than golf as provided below)
- Swim Lessons
- Skate Lessons
- Special Event Registration Fees
- Special Events Vendor Fees
- Mishawaka Market
- Recreation Registration Fees
- Adventure Day Camp
- Daily Entrance Fees for any facility

Facility Rentals:

- For any ball diamond, building, pavilion, community center room, or wedding garden rental, a refund will be granted only if the function is canceled a minimum of sixty (60) days prior to scheduled date.
- For any ball diamond, building, pavilion, community center room, or wedding garden rental, you may request one (1) date change if request is made during regular business hours and before scheduled date of use. You must speak directly to authorized office personnel for request to be honored. No request will be honored via voicemail messages.
- No refunds will be given due to inclement weather.

Eberhart Golf Course:

- Season passes, for good cause shown (e.g., medical disability, death, relocation, etc.) the Park Superintendent, will consider a refund request if said request is made within thirty (30) days from time of purchase, which date can be no later than June 30th of the year for which the Season Golf Pass has been purchased. Request for refunds will not be considered if made after this date. Any refund request considered must include a completed and signed Request for Refund Form, as well as the original purchase receipt attached thereto. Refunds requested without appropriate documentation may be delayed.
- If a refund has been approved and the pass is not used, the amount of the refund will be the cost of the pass less a \$25.00 administrative fee. If the refund is approved and the pass has been used, then the amount of the refund will be the cost of the pass less the number of rounds played at the value of a weekend resident or non-resident rate for greens fees less an administrative fee of \$25.00.

Battell Community Center Class Fees Refund:

- For good cause shown (e.g., medical disability, death, relocation, etc.) the Park Superintendent will consider a refund request if made before the class session is halfway complete. Refunds will not be given for individual class absences.
- Requests will not be considered if made after the halfway mark of class. Students will be referred to the instructor if a refund is requested after the designated class date.



*Refund policies are subject to change without further notice.

*Note: Payments made after registration deadline are subject to a late fee payment.



Mishawaka Parks and Recreation Department
Battell Community Center
904 North Main Street
Mishawaka, IN 46545
(574) 258-1664



Like us on Facebook: @MishawakaParks



Like us on Instagram: @mishawakaparks



Mishawaka Retro Fest